

# apollo

max. test head weight up to 550 kg / 1200 lbs

integrated manipulator, right swing or left swing available

extended range of vertical travel

two motorized axes as standard



# apollo

integrated manipulator

## key features

integrated manipulator available with right swing or left swing  
wide range of vertical travel to allow docking to all 300 mm probes  
tactile motor drive for vertical and rotation  
special bearing for 180° tumble as option

## specifications

### weight

max. test head weight 550 kg/1200 lbs  
system weight empty: 1000 kg/2200 lbs fully loaded: 2100 kg/4630 lbs

### linear

vertical travel (z-axis) 930 mm  
in/out (y-axis) 400 mm  
side-to-side 600 mm

### motorized

•  
-  
-

### rotation

swing cw 60° / ccw 120°  
tumble ± 3°;  
180° as option  
twist/rotation 180° ± 2°  
theta adjustment ± 2°

### motorized

-  
-  
-  
•  
-

## configurations

left swing or right swing  
configuration changeable on site  
optional tumble mode for 180° tumble

## power requirements

110 - 240 volt ac  
10 amp max.  
standard power outlet

## available adaptations (samples)

verigy: V93000 SOC and HSM series

subject to technical change  
without prior notice  
© 2007

## dimensions

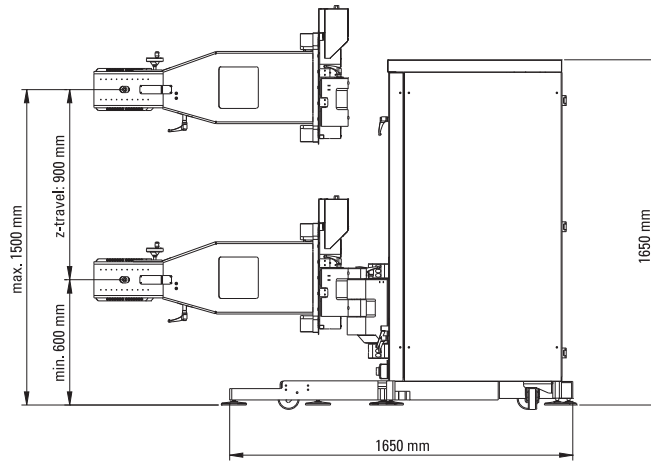
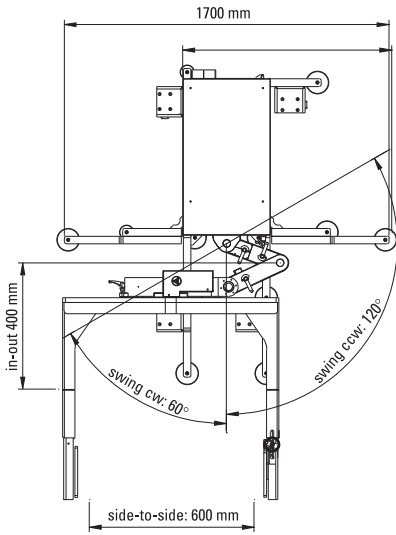

S2/S8  
conform



esmo

apollo tumble

apollo open bearing



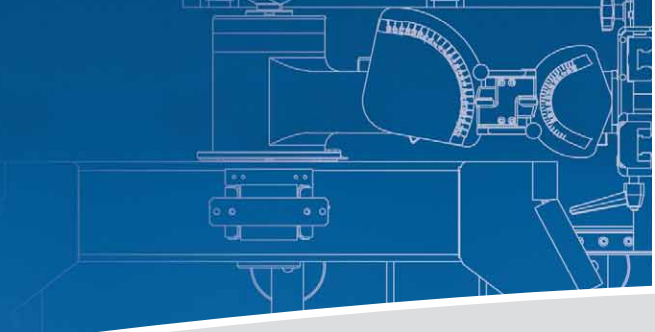

esmo ag phone +49-8031-233 88 0  
brückenstrasse 1 fax +49-8031-233 88 10  
d-83022 rosenheim sales@esmo-ag.com  
germany www.esmo-ag.com

esmo asia pte. ltd. phone +65-6562-8833  
25 international business park fax +65-6562-8860  
#03-112 german centre sales@esmo-asia.com  
singapore 609916 www.esmo-ag.com

esmo usa inc. phone +1-408-982 9911  
3350 scott blvd., suite #6102 fax +1-408-982 9933  
santa clara, ca 95054 sales@esmo-usa.com  
usa www.esmo-ag.com