

limited motion manipulator for dut up handler docking

esmo

eos

max. test head weight up to 500 kg/1100 lbs manual

minimum footprint

manual or motorized



# eos

limited motion manipulator (Imm-cart)

## key features

- cost-effective solution for dedicated dut-up docking
- minimum footprint requirement
- tactile vertical drive
- power assisted vertical move available

## dimensions

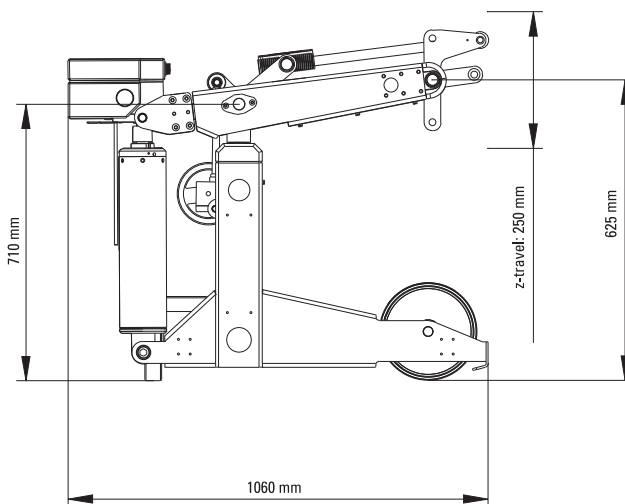
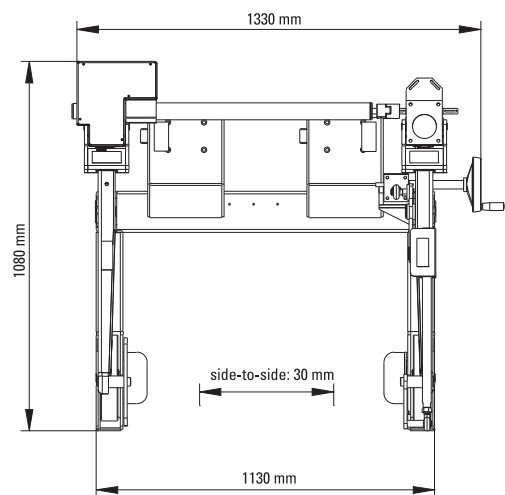

## specifications

### weight

max. test head weight 500 kg/1100 lbs  
 system weight: empty: 240 kg/528 lbs  
 fully loaded: 646 kg/1421 lbs

### linear

vertical travel (z-axis) 250 mm  
 in / out (y-axis) on rollers  
 side-to-side ± 15 mm

### rotation

tumble 90° ± 3°  
 twist/rotation ± 3° tactility  
 theta adjustment ± 3°

### motorized

○  
 -  
 -

### motorized

-  
 -  
 -

## power requirements

110 - 240 volt ac  
 10 amp. max  
 standard power outlet

## air requirement

6 bar ± 0.5 bar  
 (standard pressurized  
 air on test floors)

## configurations

manual vertical motion  
 motorized vertical motion

subject to technical change  
 without prior notice  
 © 2006



S2/S8  
 conform



esmo ag phone +49-8031-233 88 0  
 brückenstrasse 1 fax +49-8031-233 88 10  
 d-83022 rosenheim sales@esmo-ag.com  
 germany www.esmo-ag.com

esmo asia pte. ltd. phone +65-6562-8833  
 25 international business park fax +65-6562-8860  
 #03-112 german centre sales@esmo-asia.com  
 singapore 609916 www.esmo-ag.com

esmo usa inc. phone +1-408-982 9911  
 3350 scott blvd., suite #6102 fax +1-408-982 9933  
 santa clara, ca 95054 sales@esmo-usa.com  
 usa www.esmo-ag.com